

märklin
Z

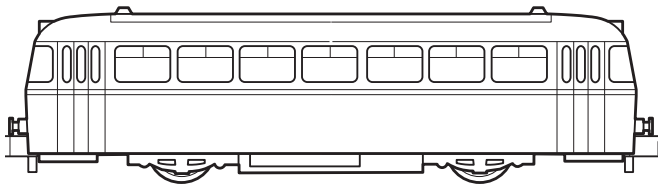

Modell des Schienenbusses

88311

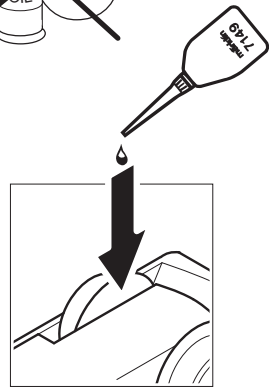
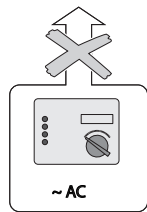
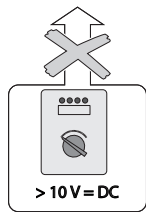
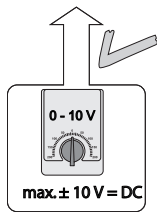
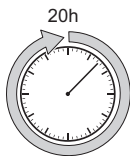

max. $\pm 10\text{ V} = \text{DC}$
67011
67020 + 67030
67201
67271

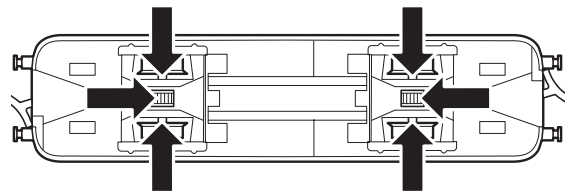

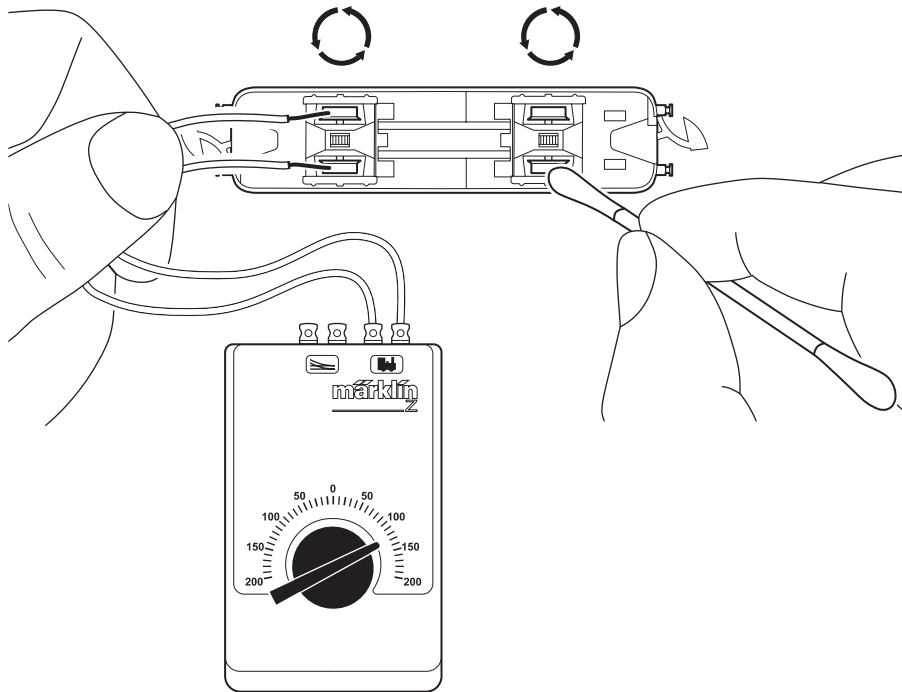

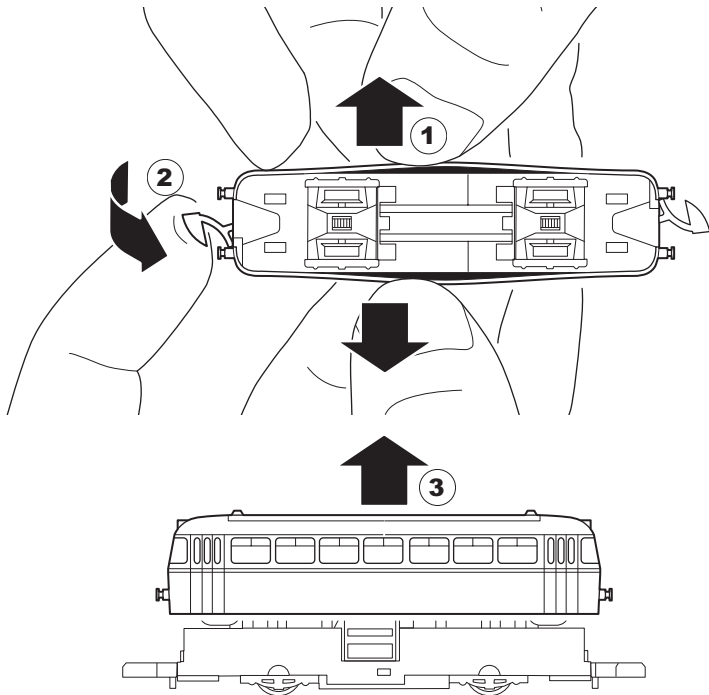



89881

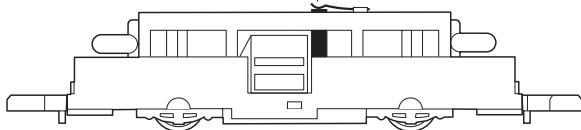
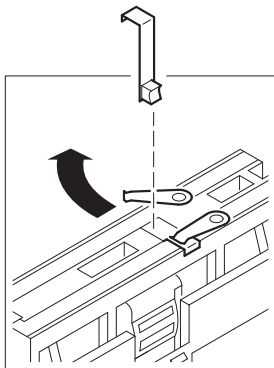

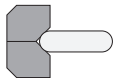

8953

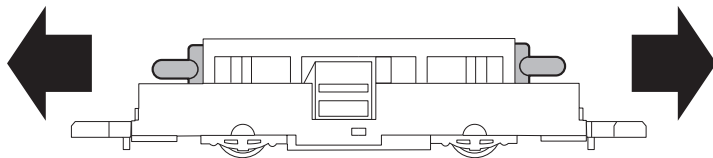
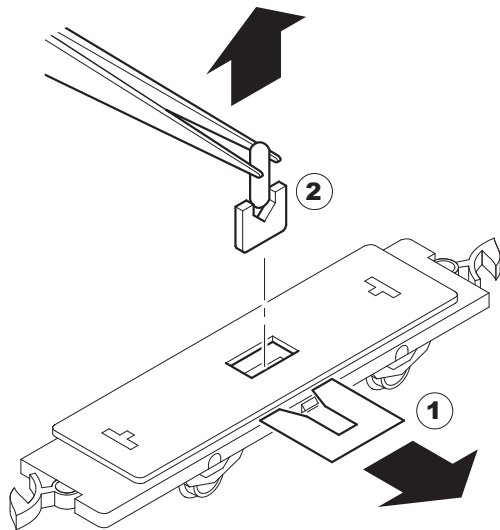
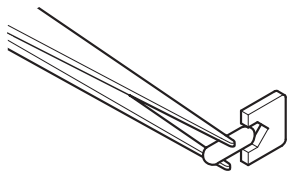

6

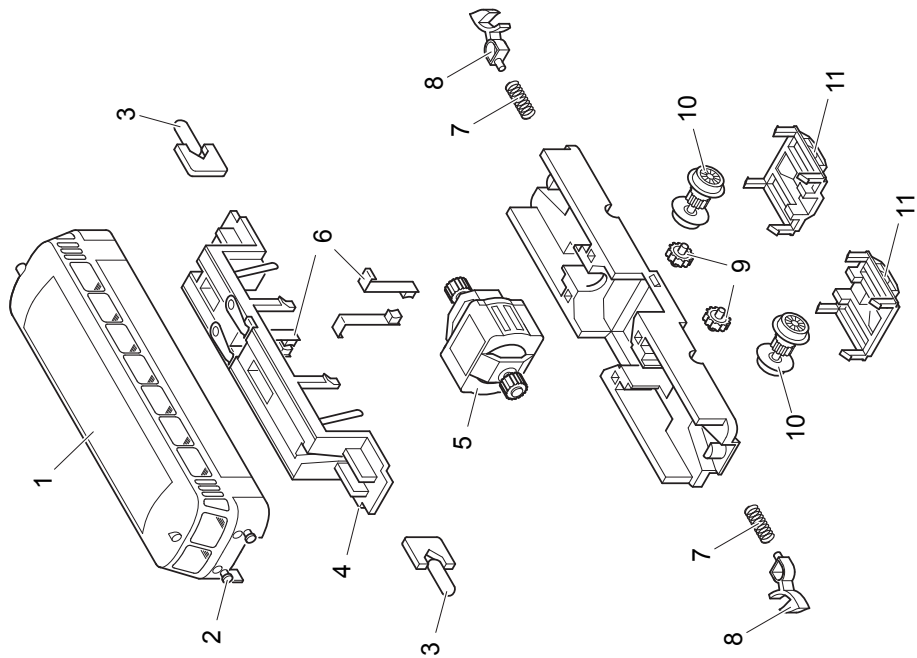

1 Aufbau	111 782
2 Puffer	262 130
3 Beleuchtungseinsatz	8 953
4 Isolierung	262 080
5 Motor	209 452
6 Motorbürsten	89 881
7 Druckfeder	765 680
8 Kupplungshaken	704 200
9 Zwischenradsatz	260 640
10 Radsatz	217 424
11 Achslagerblende	262 060
12 Aufbau	111 784
13 Puffer	262 130
14 Beleuchtungseinsatz	8 953
15 Radsatz	215 721

