

märklin

Z

Modell der Serie MY 1100 DSB/Bauart NOHAB

88632

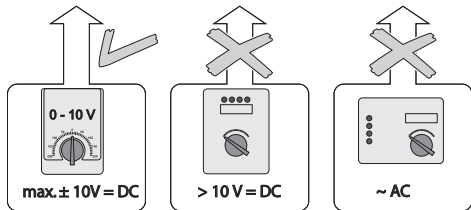

max. $\pm 10V = DC$

$> 10V = DC$

$\sim AC$

67011
67020 + 67030
67201
67271

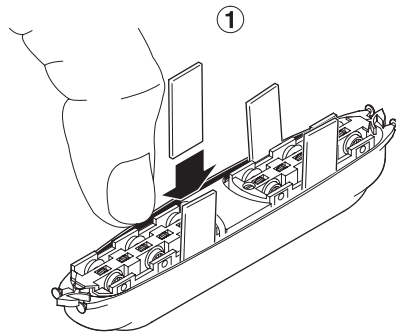

①

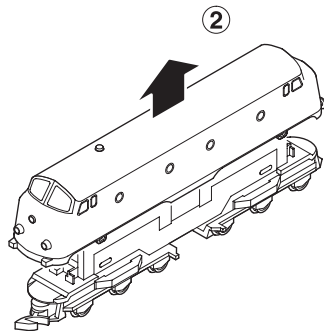

②

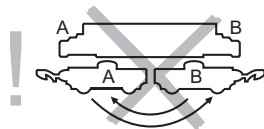
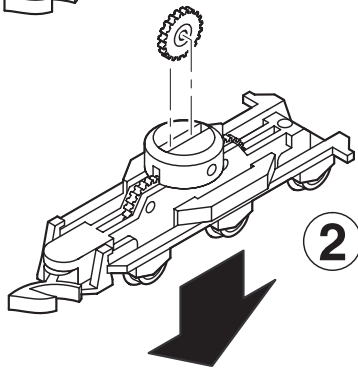
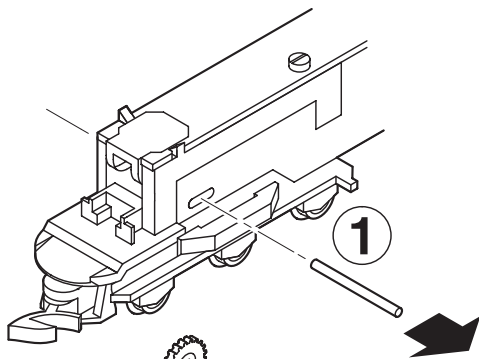

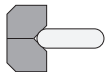

8953

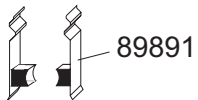

89891

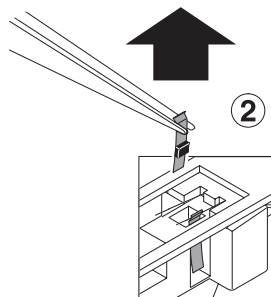
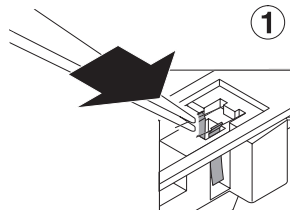
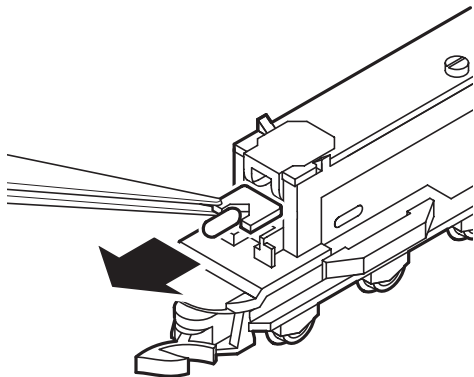

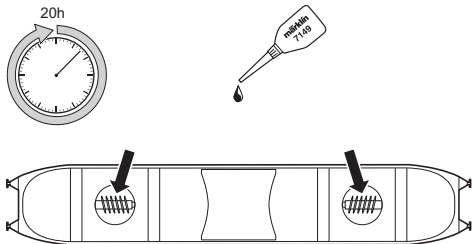

- Nur sparsam ölen (max. 1 Tropfen). Zuviel Öl führt häufig zum Verschmieren der Kollektoren und damit zur Beschädigung des Ankers.
- Oil sparingly (max. 1 drop). Too much oil frequently causes the commutator to become dirty and thereby leads to damage to the armature.

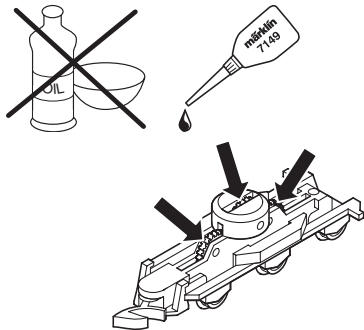

- Lubrifi ez en très petite quantité (1 goutte max.). Trop d'huile entraîne souvent l'encrassement du collecteur et à des dommages à l'induit.
- Na het aanbrengen van de oliedruppel op het motorlager het anker rondraaien. Aansluitend met een droge doek de overvloedige olie verwijderen.

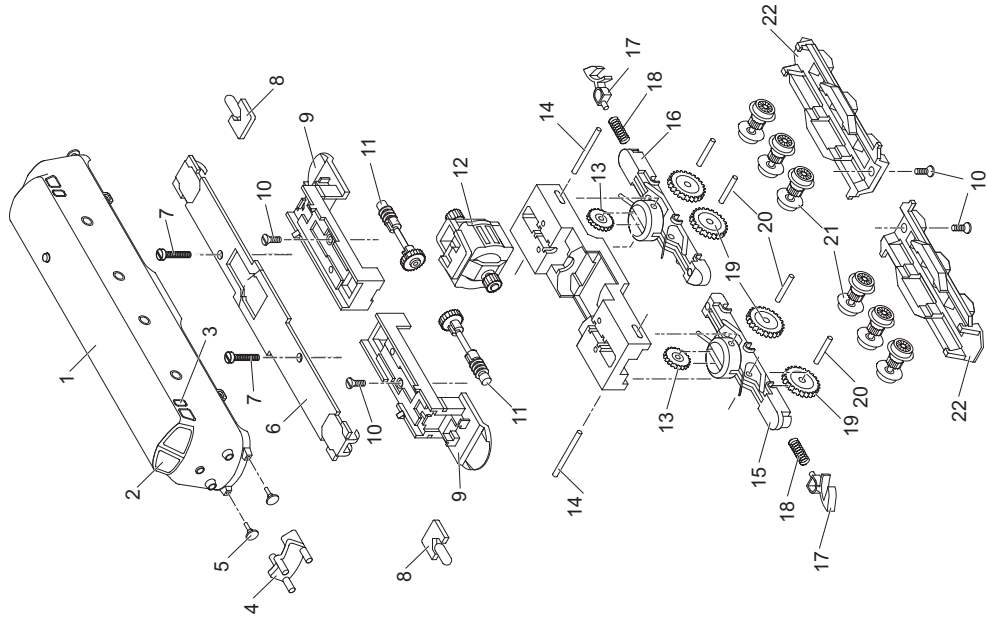

| | | |
|----|------------------------|---------|
| 1 | Aufbau komplett | 140 086 |
| 2 | Stirnfenster | 231 492 |
| 3 | Seitenfenster | 231 489 |
| 4 | Lichtkörper | 231 491 |
| 5 | Puffer | 761 790 |
| 6 | Leiterplatte | 231 771 |
| 7 | Zylinderschraube | 785 190 |
| 8 | Beleuchtungseinheit | 8 953 |
| 9 | Isolierung | 223 332 |
| 10 | Senkschraube | 785 550 |
| 11 | Antriebswelle | 262 310 |
| 12 | Motor | 211 903 |
| 13 | Zahnrad | 262 190 |
| 14 | Achse | 260 720 |
| 15 | Getriebegehäuse vorne | 262 460 |
| 16 | Getriebegehäuse hinten | 262 450 |
| 17 | Kupplungshaken | 704 200 |
| 18 | Druckfeder | 765 680 |
| 19 | Zahnrad | 260 730 |
| 20 | Achse | 262 240 |
| 21 | Treibradsatz | 216 476 |
| 22 | Drehgestellrahmen | 262 280 |

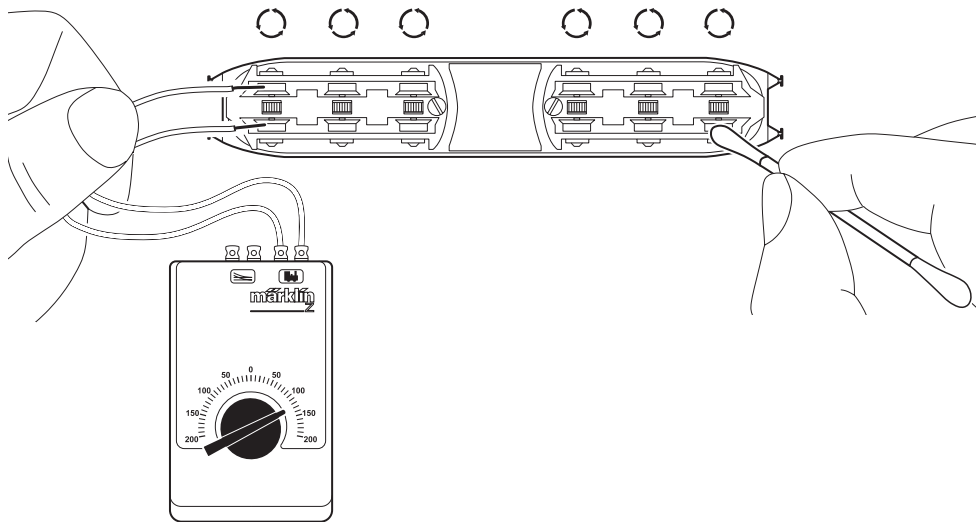

Gebr. Märklin & Cie. GmbH
Postfach 860
D-73008 Göppingen
www.maerklin.com

140091/0808/SmSk
Änderungen vorbehalten
© by Gebr. Märklin & Cie. GmbH