

märklin

Z

Modell der

BR 38

88994

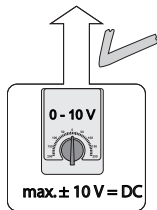

max. $\pm 10\text{ V} = \text{DC}$

67011

67020 + 67030

67201

67271

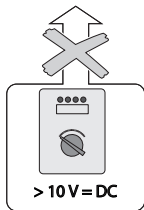

$> 10\text{ V} = \text{DC}$

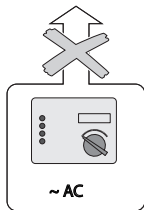

$\sim \text{AC}$

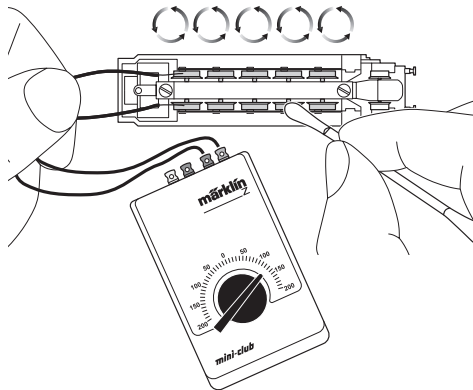

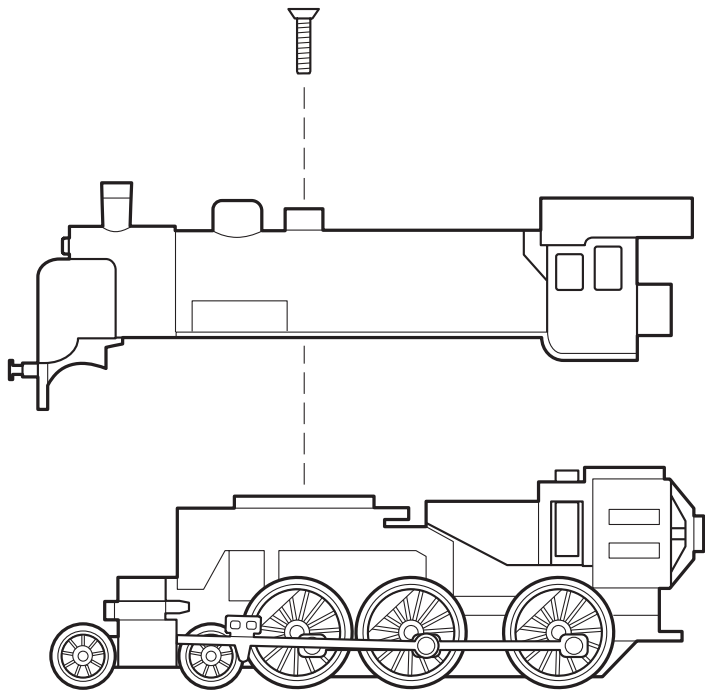

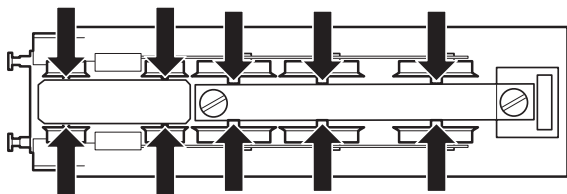
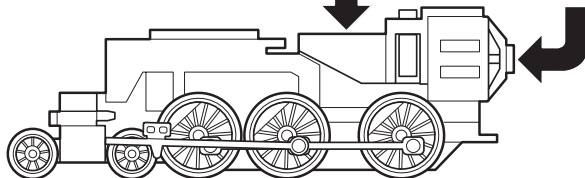
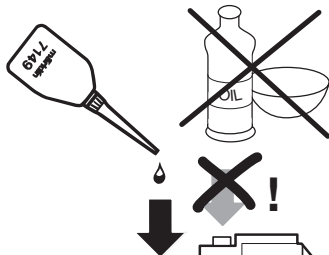
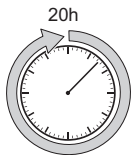

- Nur sparsam ölen (max. 1 Tropfen). Zuviel Öl führt häufig zum Verschmieren der Kollektoren und damit zur Beschädigung des Ankers.
- Oil sparingly (max. 1 drop). Too much oil frequently causes the commutator to become dirty and thereby leads to damage to the armature.
- Lubrifiez en très petite quantité (1 goutte max.). Trop d'huile entraîne souvent l'encrassement du collecteur et à des dommages à l'induit.
- Slechts spaarzaam oliën (max. 1 druppel). Te veel olie leidt vaak tot versmeren van de collector en daarmee tot beschadiging van het anker.

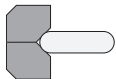

8953

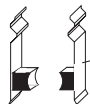
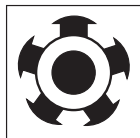
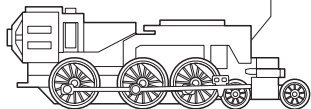
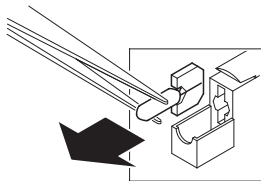

89891

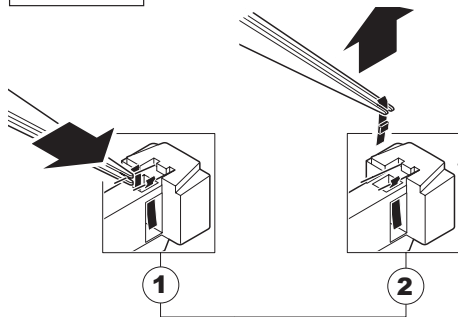

1

2

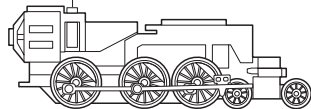

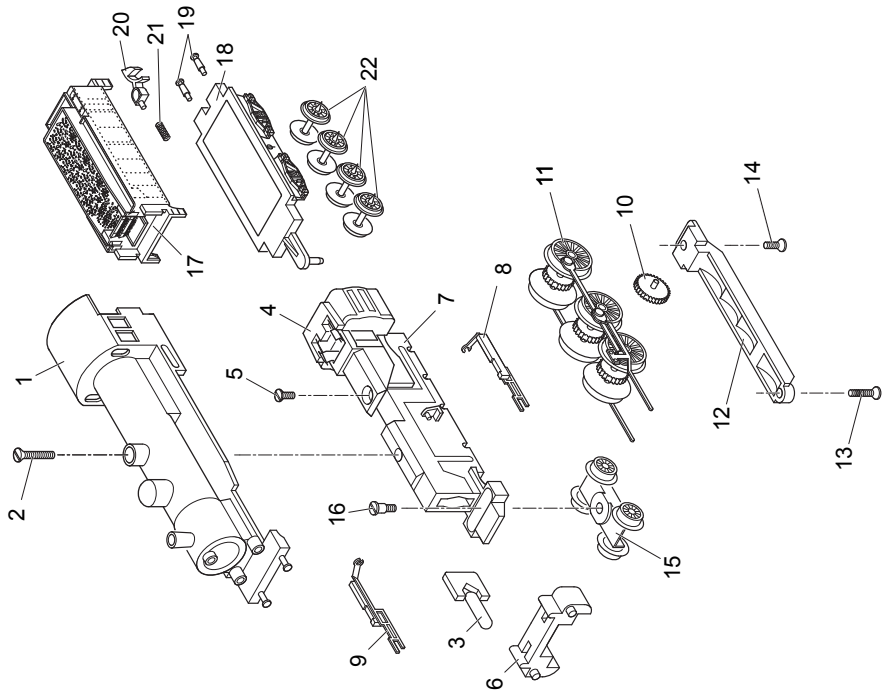

1	Aufbau komplett	108 290
2	Senkschraube	785 570
3	Beleuchtungseinsatz	8 953
4	Motor	211 912
5	Senkschraube	785 550
6	Zylinderblock	108 309
7	Traggestell	267 660
8	Kreuzkopfführung links	102 666
9	Kreuzkopfführung rechts	102 665
10	Zwischenradsatz	265 930
11	Treibradsätze mit Gestänge	108 292
12	Abdeckung	266 010
13	Senkschraube	785 570
14	Senkschraube	785 580
15	Drehgestell	108 307
16	Zylinderansatzschraube	753 130
	Tender	
17	Tendergehäuse	108 312
18	Tenderboden	299 820
19	Puffer	761 450
20	Kupplungshaken	704 200
21	Druckfeder	765 680
22	Radsatz	108 313

Gebr. Märklin & Cie. GmbH
Postfach 860
D-73008 Göppingen
www.maerklin.com

101927/0506/SmEf
Änderungen vorbehalten
© Gebr. Märklin & Cie. GmbH