

**märklin**  

---

Z

Modell der  
**BR 58**

---

**88124**

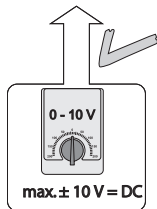

max.  $\pm 10\text{ V} = \text{DC}$

67011  
67020 + 67030  
67201  
67271

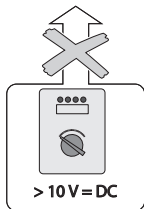

$> 10\text{ V} = \text{DC}$

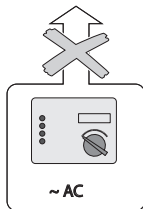

$\sim \text{AC}$

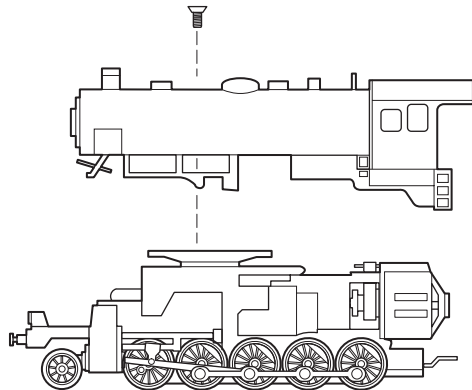

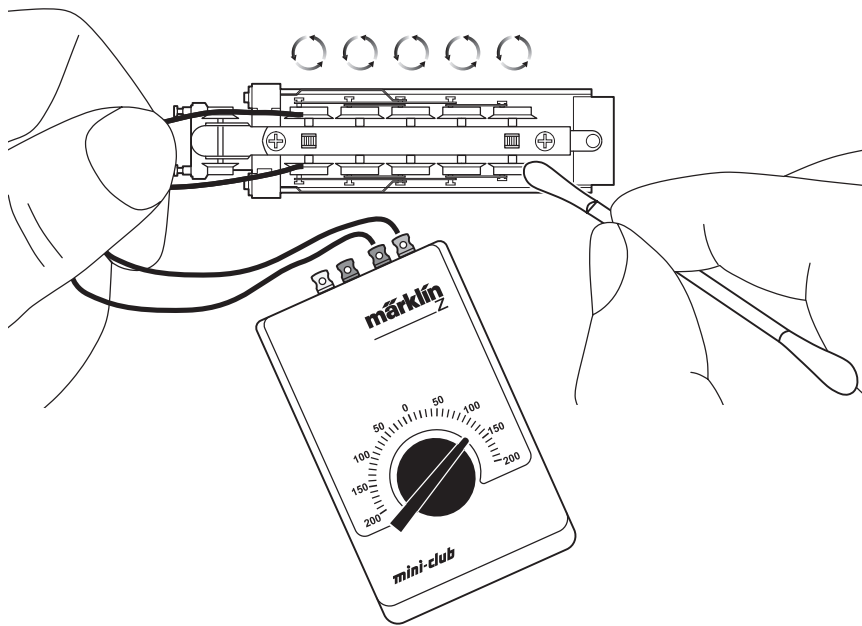

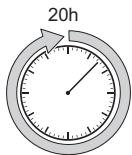

- Nur sparsam ölen (max. 1 Tropfen). Zuviel Öl führt häufig zum Verschmieren der Kollektoren und damit zur Beschädigung des Ankers.
- Oil sparingly (max. 1 drop). Too much oil frequently causes the commutator to become dirty and thereby leads to damage to the armature.
- Lubrifiez en très petite quantité (1 goutte max.). Trop d'huile entraîne souvent l'encrassement du collecteur et à des dommages à l'induit.
- Slechts spaarzaam oliën (max. 1 druppel). Te veel olie leidt vaak tot versmeren van de collector en daarmee tot beschadiging van het anker.

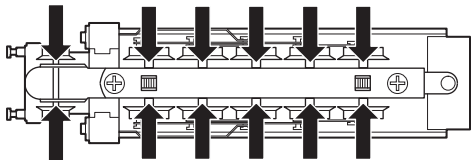
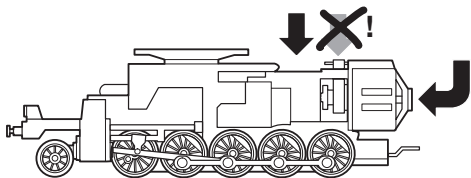

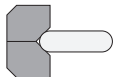

8953

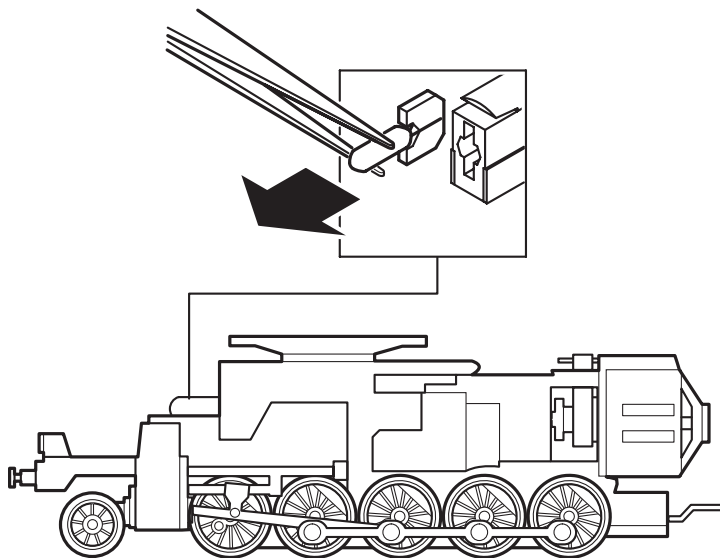

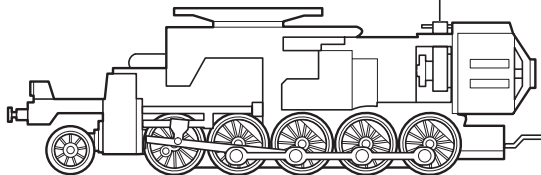
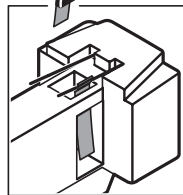
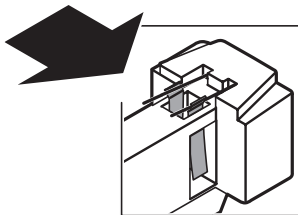
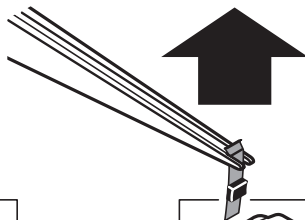
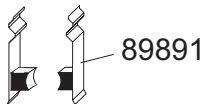

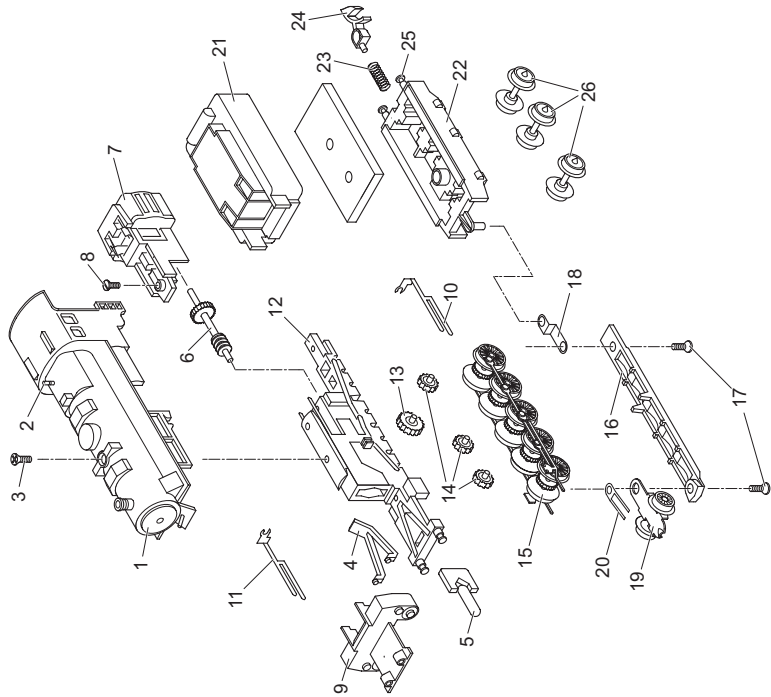

|                              |         |
|------------------------------|---------|
| 1 Aufbau                     | 152 933 |
| 2 Pfeife                     | 152 935 |
| 3 Schraube                   | 785 550 |
| 4 Lichtkörper                | 231 692 |
| 5 Beleuchtungseinsatz        | 8 953   |
| 6 Antriebswelle              | 231 683 |
| 7 Motor                      | 211 915 |
| 8 Schraube                   | 785 550 |
| 9 Zylinderblock              | 152 940 |
| 10 Kreuzkopfführung links    | 231 697 |
| 11 Kreuzkopfführung rechts   | 231 693 |
| 12 Treibgestell              | 115 520 |
| 13 Zwischenradsatz           | 231 687 |
| 14 Zwischenradsatz           | 231 688 |
| 15 Treibradsatz mit Gestänge | 152 939 |
| 16 Abdeckung                 | 231 686 |
| 17 Schraube                  | 785 550 |
| 18 Kuppelblech               | 267 330 |
| 19 Laufgestell komplett      | 107 582 |
| 20 Feder                     | 231 684 |

|                   |         |
|-------------------|---------|
| Tender            |         |
| 21 Tendaraufbau   | 152 942 |
| 22 Boden          | 106 284 |
| 23 Druckfeder     | 765 680 |
| 24 Kupplungshaken | 704 200 |
| 25 Puffer         | 761 480 |
| 26 Radsatz        | 215 721 |

**WARNUNG!** Dieses Produkt enthält Magnete. Das Verschlucken von mehr als einem Magneten kann unter Umständen tödlich wirken. Gegebenenfalls ist sofort ein Arzt aufzusuchen.

**WARNING!** This product contains magnets. Swallowing more than one magnet may cause death in certain circumstances. If necessary, see a doctor immediately.

**ATTENTION !** Ce produit contient des aimants. L'ingestion de plusieurs aimants peut être mortelle. Le cas échéant, consulter immédiatement un médecin.

**LET OP!** Dit product bevat magneten. Het inslikken van meer dan één magneet kan onder bepaalde omstandigheden de dood tot gevolg hebben. Waarschuw direct een arts.